

YN600L II

Pro LED Video Light

User Manual

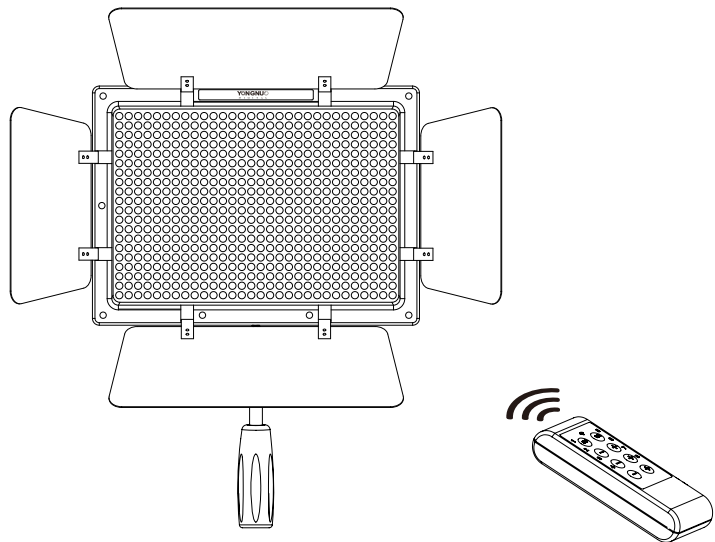

Before using this product, please read this user manual carefully and keep it properly for reference.

Overview

First of all, thank you for using the YONGNUO YN600L II LED video light. This video light is formed by 600 lamp beads of extra-large luminous chips, with higher brightness in same energy consumption; it adopts the latest LED driving technology, definitely not appear the corrugated, stroboscopic and other negative phenomena when shooting; it adopts the encoder digital dimming mode, thus the video light can be dimmed accurately and reliably; built-in 2.4G wireless remote control system; equipped with 8 channels grouping function; equipped with battery level test; besides, it can be remote controlled or mobile wireless remote control, group control the brightness and other powerful function of the LED video light.

I. Product Structure

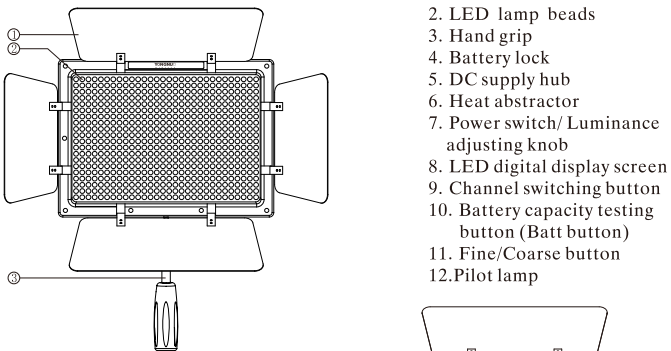

Remote Controller Structure

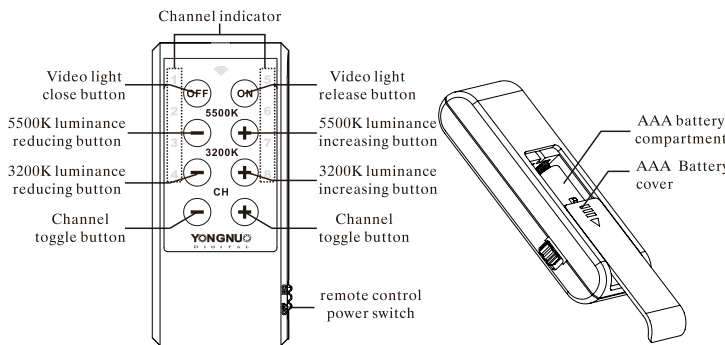

II. Function Introduction

- YN600L II is equipped with multi channel wireless remote controller which is used to adjust the luminous intensity and control the switch of YN600L II. Furthermore, it is very convenient to use this controller to control the luminous intensity and the switches of 8 groups of video lights.
- A mobile APP is provided on our official website. With this mobile APP, you can control this LED video light with your mobile phone, read the current parameter of the luminous intensity and channel, and, control the luminous intensity and the switches of 8 groups of video lights individually. You can control your LED video light as needed.
- YN600L II adopts 600 high-quality LED lamp beads with chips of extra-large luminous area. In the same energy consumption, the luminous intensity is greater, the facular is more uniform and the service life is longer.
- YN600L II adopts YONGNUO proprietary LED driving technology which does great help to effectively avoid corrugation and stroboscopic flash.
- YN600L II adopts encoder digital dimming system, including coarse tuning mode and fine tuning mode.
- On the LED digital display screen of YN600L II, the parameter of the power output is intuitional.
- Shooting for long time is possible because YN600L II supports external DC power input (power adapter is optional).
- The fan forced heat dissipation YN600L II adopts solves the heating problem after the long use of LED video light.
- YN600L II, equipped with 2 pieces of color temperature filters, can be used under different circumstances.

III. Method of Application

1. Battery Installation

- When the lithium battery is mounted, the battery should be mounted to the card groove according to the arrow direction; when installed a battery, 300 LED lamp beads can be lighted, other functions can be normally used; when installed two batteries, 600 LED lamp beads can be lighted.

Note: It is recommended to use Yongnuo NP-F750 battery to get more durable shooting time. The maximum capacity of the battery is 5200mAh. In the highest brightness, it can be used for about 60 minutes. please remove the battery when not in use.

- When removing the lithium batteries, please press the battery lock and then take out the lithium batteries.

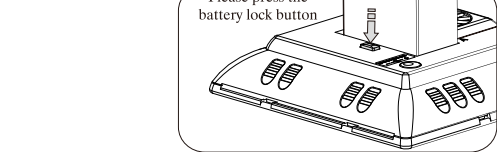

2. Fasten Video Light As Follow As Needed:

- Fasten the video light to the tripod directly

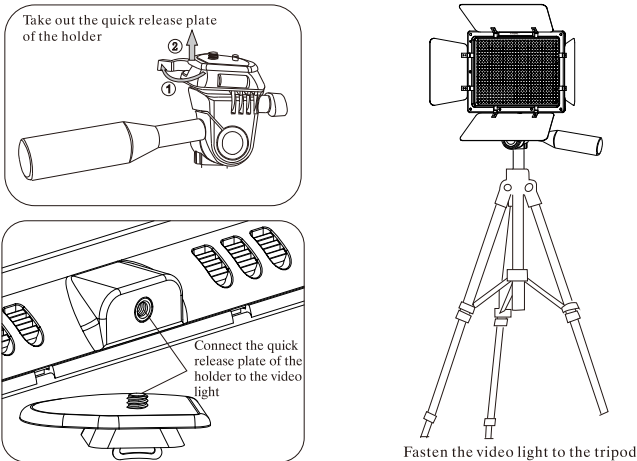

- Multifunctional Type-D lamp holder is an optional choice for fixing the video light to the film studio, light stand, tripod.

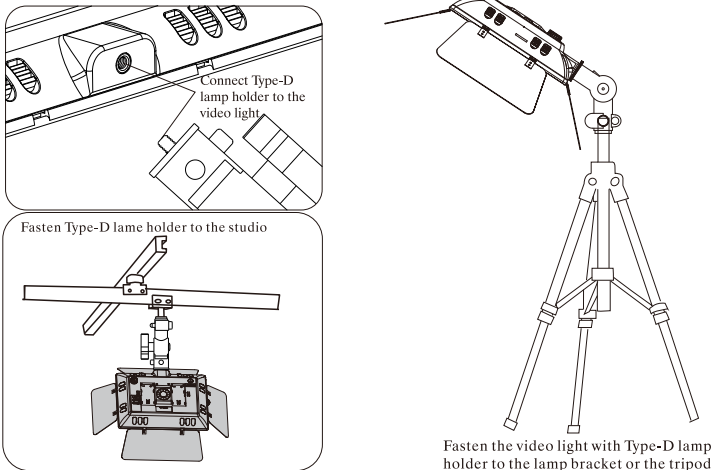

- Fasten the video light to the handle attached

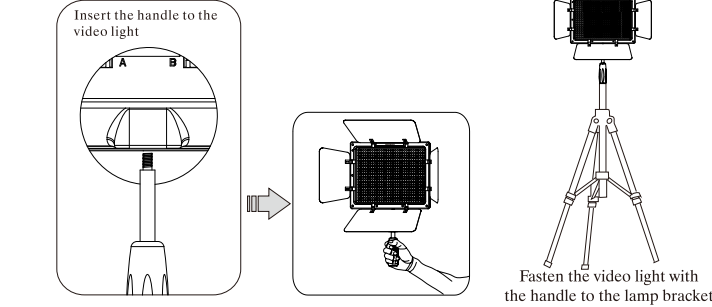

3. Start-up and adjust the brightness

- When pressing the power switch button, the LED video light will light up; rotate this button rightwards the brightness of the LED video light will increase while leftwards will reduce.

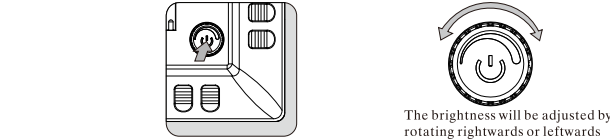

b. Brightness Control Mode Switching

It is divided into coarse tuning and fine tuning, more convenience for use. Press the coarse tuning/fine tuning switching button to switch to coarse tuning/fine tuning. When the 【C】 indicator light up, the LED video light will enter into coarse adjustment and the luminance will be adjusted with 10% as an adjusting grade. Press the button again will switch to fine tuning mode, the 【Fine】 indicator light up, the LED video light will enter into coarse adjustment and the luminance will be adjusted with 1% as an adjusting grade.

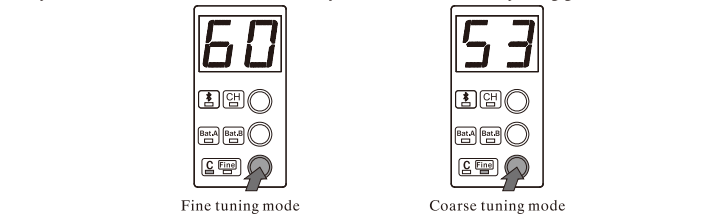

5. Battery Electricity Quantity Test

Press the battery electricity quantity test button to test the electric quantity, when the pilot lamp of Bat.A light up, the LED display screen shows the battery level for battery A. Press the battery electricity quantity test button again when the pilot lamp of Bat.B light up, the LED display screen shows the battery level for battery B. The power readings between P0-P9 means 0%-90% of the battery level. For example, the battery level is 30% as the right picture battery A shown, the battery level of battery B is 90% (Note: the rest electric quantity of test when the brightness is low is different from that of the test when the brightness is high, the service life is tested under the current brightness).

5. Channel Switch

Press the channel switch button CH can switch the receiving channel, the display screen appears H1 to H8, switch the remote control channel to CH2, then the remote controller can adjust the LED video light. If you own multiple this type of the LED video light, it could be grouped control the brightness and switch, maximum can be divided into 8 groups.



7. External Power Supply

It is recommended to use YONGNUO power adapter with YN600L II to obtain lasting service time. When using external power supply, the video light will stop the battery power supply automatically and will not get the battery charged. The external power supply interface outside is positive and the interface inside is negative. The input voltage is 8V and the electric current is 5A. Note: If YN600L II defective when it is used with power adapter of other brands, YN600L II will no longer be guaranteed for repair.

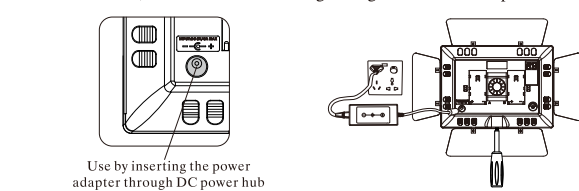

8. Fan Heat Dissipation

YN600L II adopts intelligent fan heat dissipation, which is effective to emit the heat of LED video light after long time use, reduce lumens depreciation and extend service life. The fan runs automatically. To ensure the service life of YN600L II, please do not force the fan stop running, and keep the way between the air intake and the heat dissipation hole clear and unblocked.

IV. Color Temperature Filters

YN600L II comes with two pieces of CT filters. Simply insert the CT filters into the side slot to meet your requirement in different circumstances.

V. Remote Dimming Mode

The wireless remote controller attached can adjust the luminous intensity and control the switches of YN600L II. The maximum remote controlling distance is up to 15 meters.

VI. Mobile APP Remote Control

The product supports mobile remote control (supports Android 4.3 or above blue tooth carried 4.0 smartphone/ IOS7.0 and iPhone4S or above version phone), the APP can be downloaded from the YONGNUO official website or download through scanning the two-dimension code on the gift box.

1. Introduction of APP Control Page

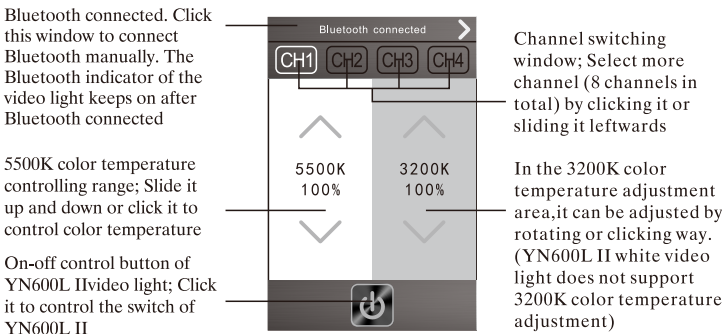

VII. Product Specification

Light Source	600 LED beads	Luminance Angle	55°
Color Temperature	5500K	Control distance	>15M
Color Rendering Index	≥95	Remote control	2. 4G
Output power	36W	Mobile control	Bluetooth 4.0
Lumen	4800LM	Compatible batteries	Two NP-F750 series lithium batteries
Average Service Life	50000H	External power source	8V 5A DC power supply
Weight	1326g	Size	260*188*40MM
Contents: Video light (1), Remote controller (1), Handle (1), User Manual (1), Quick guide (1), Using example (1), CT Filters (2) Note: Please contact your dealer if anything missing.			

VIII. Failure Analysis and Troubleshooting

When using this product, you may encounter the following problems:

Description	Cause	Troubleshooting
No reaction after power on	Low Battery	Install new batteries or connect external power supply
	Damaged circuit board	Depot repair
Inadequate or low luminance at the greatest luminous intensity	Low battery	Install new batteries or re-charge the batteries
Inaccurate battery capacity test: low battery in high luminance and full battery in low luminance.	The battery capacity indicates the length of time available for the use in the current luminance. Higher luminance required more power and the length of time available for use will be shortened, so the battery capacity shown gets lower	Normal phenomenon and no measure needed
The video light can't be controlled remotely.	Too far away	Ensure the remote control distance is no more than 15 meters
	Remote control and LED light are on different channels	pls refer to User Manual to reset channel
The cooling fan sometimes works and sometimes stops working.	The cooling fan is automatically controlled by the LED video light, which cannot be manually turned on and off.	Normal phenomenon
The pilot lamp on the remote controller is dimming	Low battery	Replace two AAA batteries
Screen display E1	The external power supply voltage is too high.	Please correct use the external power source, high voltage will cause permanent damage to the LED video Light and could not be repaired. The LED video light supports the input voltage is 8V, the electric current more than or equal to 5A. It is recommended to use the LED light optional power adapter, which can be purchased through the distributor.

Dealer: SHENZHEN YONGNUO PHOTOGRAPHY EQUIPMENT Co., Ltd
Add: 2-B509 Saige Science & Technology Park, North Huaqiang Rd, Futian District, Shenzhen, China
TEL: 0755-8376 2448
FAX: 0755-8376 2765
Web: www.hkyongnuo.com
Manufacturer: SHENZHEN YONGNUO ELECTRIC APPLIANCE Co., Ltd
Add: NO.1 Workshop, Tong Le Wen Hao Industrial Factory District, Longgang Sub-district, Longgang District, Shenzhen, China
TEL: 0755-8480 8443
After-sales Service TEL: 400-0013-888